

PROPERTY OWNERS AND MINERAL RIGHTS OWNERS LIST*

1. City of Victoria
700 Main Center
Suite 108
P.O. Box 1758
Victoria, Texas 77902
2. Helen M. Pargac
507 North Washington
Victoria, Texas 77901
3. Anthony Daniel
P.O. Box 181
Tivoli, Texas 77990
4. City of Victoria
700 Main Center
Suite 108
P.O. Box 1758
Victoria, Texas 77902
5. City of Victoria
700 Main Center
Suite 108
P.O. Box 1758
Victoria, Texas 77902
6. Donald Jansky Et Ux
6034 N. State Highway 119
Yorktown, Texas 78164
7. Jimmy Burney*
2214 Fancy Gap Lane
Austin, Texas 78745
Wanda H. Maddox*
3101 Locke Lane
Austin, Texas 78709
8. J. R. Suddarth Family Investment LTD
11836 Stuckey Lane
Houston, Texas 77402

* In accordance with Title 30 Texas Administrative Code §330.59(e)(3), the availability of mineral ownership beneath the facility has been investigated. Based on conversations with the Victoria County Appraisal District, their records do not include mineral ownership.

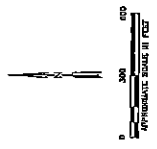

--- PERMIT BOUNDARY
 --- 500 FOOT RADIUS
 --- PROPERTY LINE

NOTES:

1. ① REFERS TO PROPERTY OWNERS LISTED ON PROPERTY OWNERS LIST.
2. PROPERTY OWNERS WITHIN 500 FEET OF THE PERMIT BOUNDARY ARE SHOWN.
3. PROPERTY OWNERS LIST FROM 2007 VICTORIA COUNTY APPRAISAL DISTRICT RECORDS.

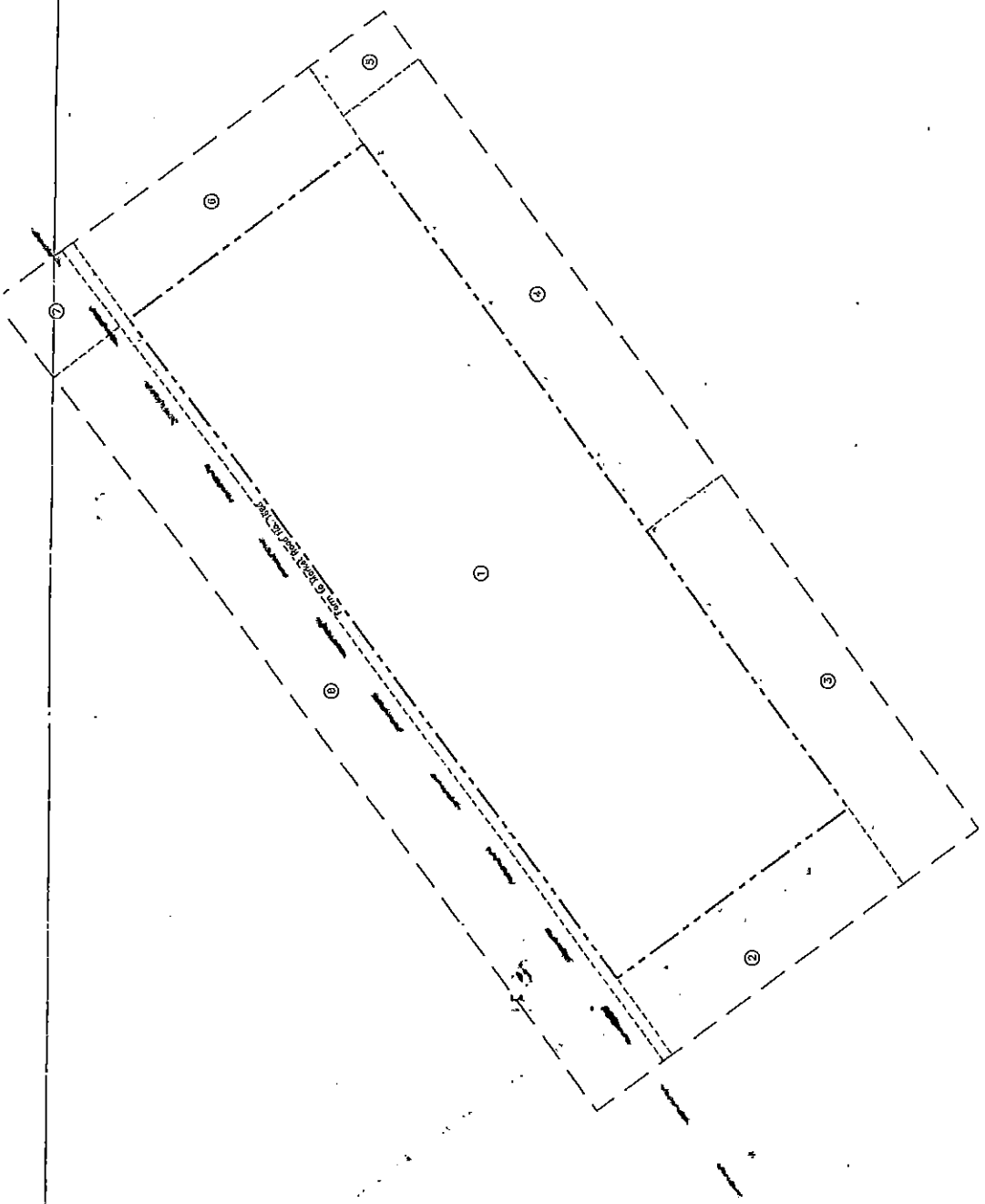

<input type="checkbox"/> DRAFT <input type="checkbox"/> FOR PERMITTING PURPOSES ONLY <input type="checkbox"/> BEING FOR CONSTRUCTION <input type="checkbox"/> CLIENT APPROVAL ONLY		PREPARED FOR CITY OF VICTORIA		PROPERTY OWNERS MAP CITY OF VICTORIA LANDFILL VICTORIA COUNTY, TEXAS	
DATE TIME DRAWN BY CHECKED BY	PROJECT NO. SHEET NO. OF TOTAL SHEETS	REVISIONS NO. DATE DESCRIPTION	<i>Heaver Boos Consultants</i> OFFICE: 1000 W. 11th Street, Suite 100, Victoria, TX 77901 PHONE: 361-571-1234 FAX: 361-571-1235 WWW: www.heaverboos.com		